



# Dream Maker

At Lakeside Estates

- Private Sundeck
- Easiest walk to the lake
- Looks right at the Jumping Bridge
- Private Boat Dock with room for 3 boats
- 2 living areas for a gentle vacation



Sleeps 20		2 Living Rooms		1.5 Kitchens		3 Decks	
Bedrooms	6	Couches	4	Refrigerators	2	Grills	1
Bathrooms	3.5	Love Seats	2	Coffee Makers	1	Tables	0
King Beds	1	TV1	42" DVD	Blender	1	Seats	20
Queen Beds	2	TV2	42"	Mixer	0	Picnic Tables	2
Double Beds	7	TV3	42"	Dining 1tables	1	Hot tub	Private
Twin Beds	0	TV4	32"	Tables seat	18	Dock	Private
Sofa Beds	1					Slips	3 (1 covered)

Internet Access	Phone Service	Pet Friendly
No	Local Only	Yes

EXTRAS: Kitchenet downstairs, Foosball table

Rates		Weekly/Daily PLUS 14.25% TAX		
Mid May- Early June	Early June-Late Aug	Late Aug-Mid Sept	Med Sept – Mid May	Cleaning
\$2,880 / \$480	\$3,600/\$720	\$2,880 / \$480	\$1,800 / \$300	\$240

## Contact

Jon Trimbach at (937) 238-5643 or [Jon@NorrisLakeProperties.com](mailto:Jon@NorrisLakeProperties.com)  
 Rick Trimbach at (937) 271-0012 or [Rick@NorrisLakeProperties.com](mailto:Rick@NorrisLakeProperties.com)



# Dream Maker II

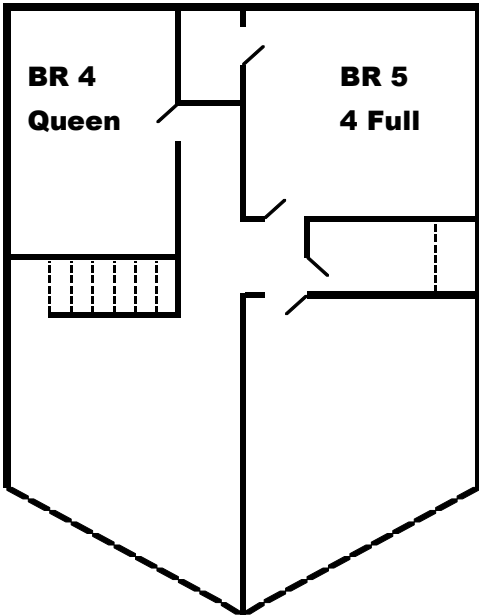
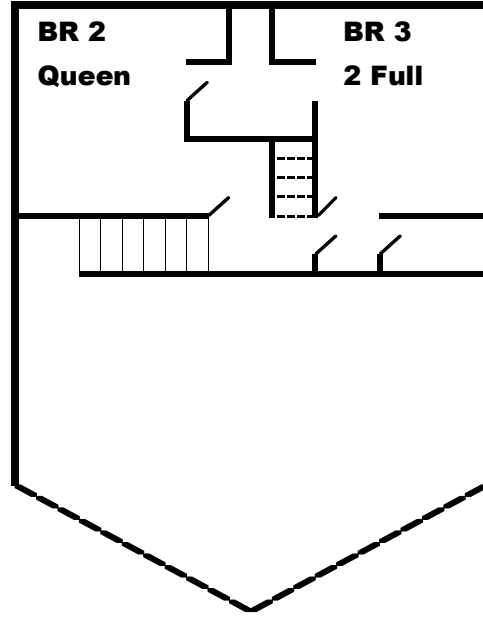
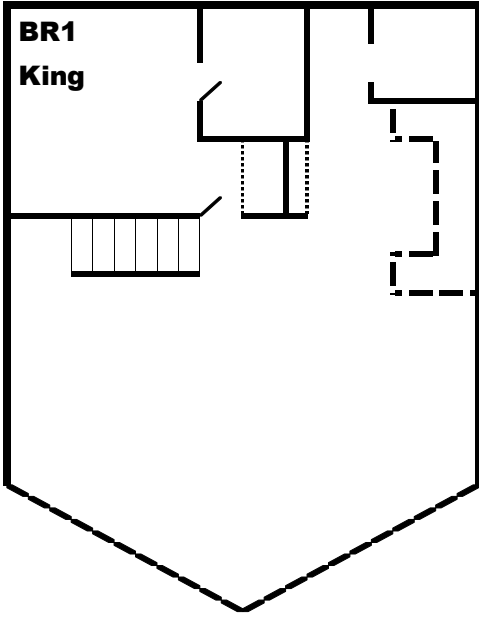

I

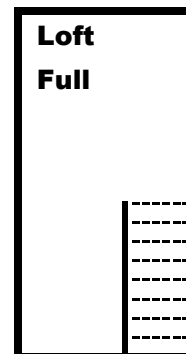

Bedroom 1 King  
Bedroom 3 2 Full  
Bedroom 5 4 Full

Bedroom 2 Queen  
Bedroom 4 Queen  
Bedroom 6 Full

